

# TECHNICAL DATA SHEET - G&G Bag HOUSE FILTER

<b>Filter type:</b>	G&G-Bag-HOUSE-14-15-152-40-A
<b>Producer:</b>	G&G filtration CZ, s.r.o.

## Parameters of filtered gas

A1	Operating amount of filtered gas	24 100	m <sup>3</sup> /h
A2	Operating temperature	20	°C
A3	Amount of filtered gas (0°C)	22 460	Nm <sup>3</sup> /h
A4	Inlet dust concentration	300	g/m <sup>3</sup>
A5	Operating pressure drop	1 200	Pa
A6	Maximum pressure drop	2 200	Pa

## Filter media parameters

B1	Shape of filter medium		round hoses
B2	Type of filter medium		m-Aramid
B3	Density of filter medium	530	g/m <sup>2</sup>
B4	Breathability filter media	300	mm/s @ 200 Pa
B5	Continuous temperature resistance	200	°C
B6	Momentary temperature resistance	220	°C

## Filter equipment parameters

C1	Number of filter rods	210	ks
C2	Total filter area	401	m <sup>2</sup>
C3	A/C parameter	1,00	m <sup>3</sup> /m <sup>2</sup> /min
C4	Can velocity	1,06	m/s
C5	Flow from below the rods	24 100	m <sup>3</sup> /h
C6	Hose side flow	-	m <sup>3</sup> /h
C7	Polluted gas input		<i>into the filter hopper</i>

## Dimensions of the filter part

D1	X-axis filter size	3 178	mm
D2	Y-axis filter size	3 190	mm
D3	The gap between the individual rods	55	mm
D4	Gap between filter rods with filter walls	70	mm
D5	Gap between rods and hopper	100	mm

## Filter media arrangement

E1	Orientation of filter rods		vertical
E2	Diameter of filter rods	152	mm
E3	Length of filter rods	4 000	mm
E4	Rods attachment		snapping
E5	Inlet nozzle shape		venturi

## Regeneration system

F1	Number of regeneration valves	14	pcs
F2	Size of regeneration valves	2"	
F3	Total compressed air consumption	40	Nm <sup>3</sup> /h
F4	Compressed air pressure	6	bar

## Dimensions of the filtration device

G1	Total width of the filter	3 386	mm
G2	Total filter depth	3 398	mm
G3	Total filter height	9 000	mm
G4	Weight of the filter device	9 413	kg
G5	Emergency weight 1/3 hopper	564	kg
G6	Total weight incl. emergency filling	9 977	kg
G7	Foot load	4x 2495	kg

## Dimensions of connecting flanges

H1	Contaminated gas inlet flange	Ø800	mm
H2	Clean gas outlet flange	400 x 1750	mm
H3	Hopper connecting flange	250 x 250	mm
H4	Filter foot size	250 x 250	mm

## Material design of the filter

I1	Filter chamber material	11375	
I2	Hopper material	11375	
I3	Filter housing material thickness	4	mm
I4	Hopper material thickness	5	mm
I5	Thickness of stiffeners	8	mm
I6	Coating system	C4	

## Material of thermal insulation

J1	Type of thermal insulation		mineral wool
J2	Coefficient of thermal conductivity	0,038	W/m.K
J3	Insulation thickness	100	mm
J4	Insulation cover		galvanized sheet metal
J5	Total insulation area of the cabinet	76,1	m <sup>2</sup>
J6	Total insulation area of the hopper	20,5	m <sup>2</sup>

## Hopper heating

K1	Hopper heating system		electric resistance cable
K2	The total area of the heated part	18,5	m <sup>2</sup>
K3	Heating power per 1 m <sup>2</sup>	200	W
K4	Total heating power	3700	W



# TECHNICAL DATA SHEET - G&G Bag HOUSE FILTER

Filter type:

G&G-Bag-HOUSE-14-15-152-40-A

Producer:

G&G filtration CZ, s.r.o.

## Orientation drawing

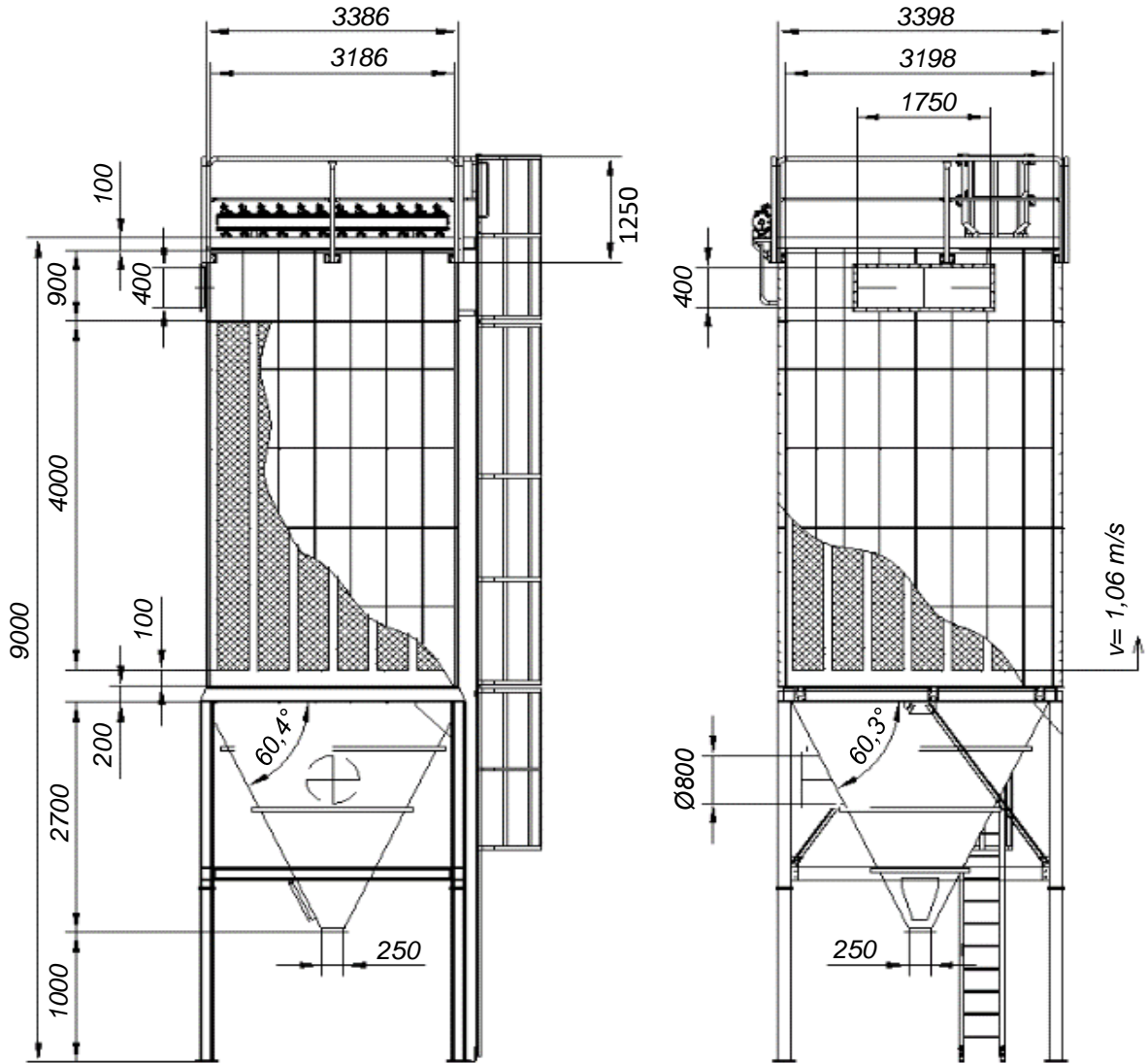

$m=9413 \text{ kg}$

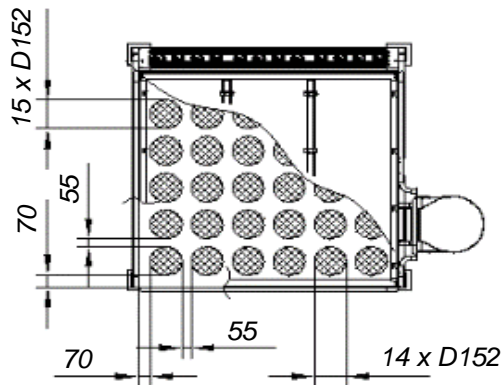

*this is an orientation drawing*

## Files for download

STEP: <https://download.ggfiltration.com/G&G-Bag-HOUSE-14-15-152-40-A.step>

DWG: <https://download.ggfiltration.com/G&G-Bag-HOUSE-14-15-152-40-A.dwg>



G&G filtration CZ, s.r.o.  
Hrubínova 1903/9  
664 51 Šlapanice  
Czech republic

IČO: 05226953  
DIČ: CZ05226953  
info@gg.cz  
info@ggfiltration.com